

Farrier House Priory Street
, Hertford, SG14 1RN
£1,400 Per month

2 1 1 c

Farrier House Priory Street, Hertford, SG14 1RN

Greenhill Estates are delighted to be marketing for let this TOWN CENTRE two bedroom mews house set within a small development and situated within walking distance of Hertford Town Centre and Hertford East mainline railway station serving access to London Liverpool Street and Tottenham Hale train stations.

This modern house is immaculately presented offering contemporary and period features throughout. Downstairs, there is a spacious open plan living area with a modern high specification kitchen including a built-in breakfast bar and fully integrated 'Bosch' appliances. To the first floor are two bedrooms and a modern bathroom, features of the bedrooms are the vaulted ceilings and a Juliette balcony off the main bedroom.

The property is set within a small development that forms part of a four year old conversion and is offered with allocated parking.



Area Map



Floor Plan

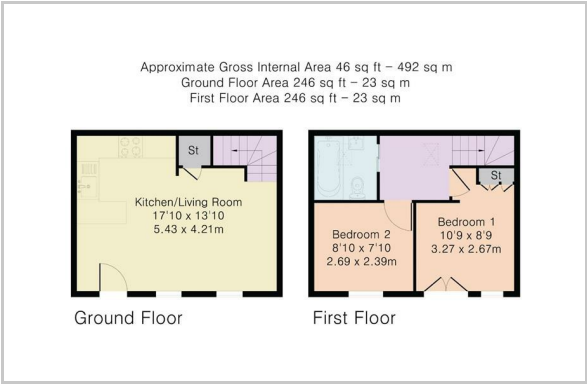

Energy Efficiency Graph

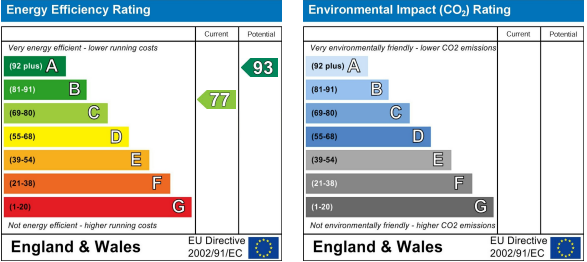

These particulars, whilst believed to be accurate are set out as a general outline only for guidance and do not constitute any part of an offer or contract. Intending purchasers should not rely on them as statements of representation of fact, but must satisfy themselves by inspection or otherwise as to their accuracy. No person in this firms employment has the authority to make or give any representation or warranty in respect of the property.